

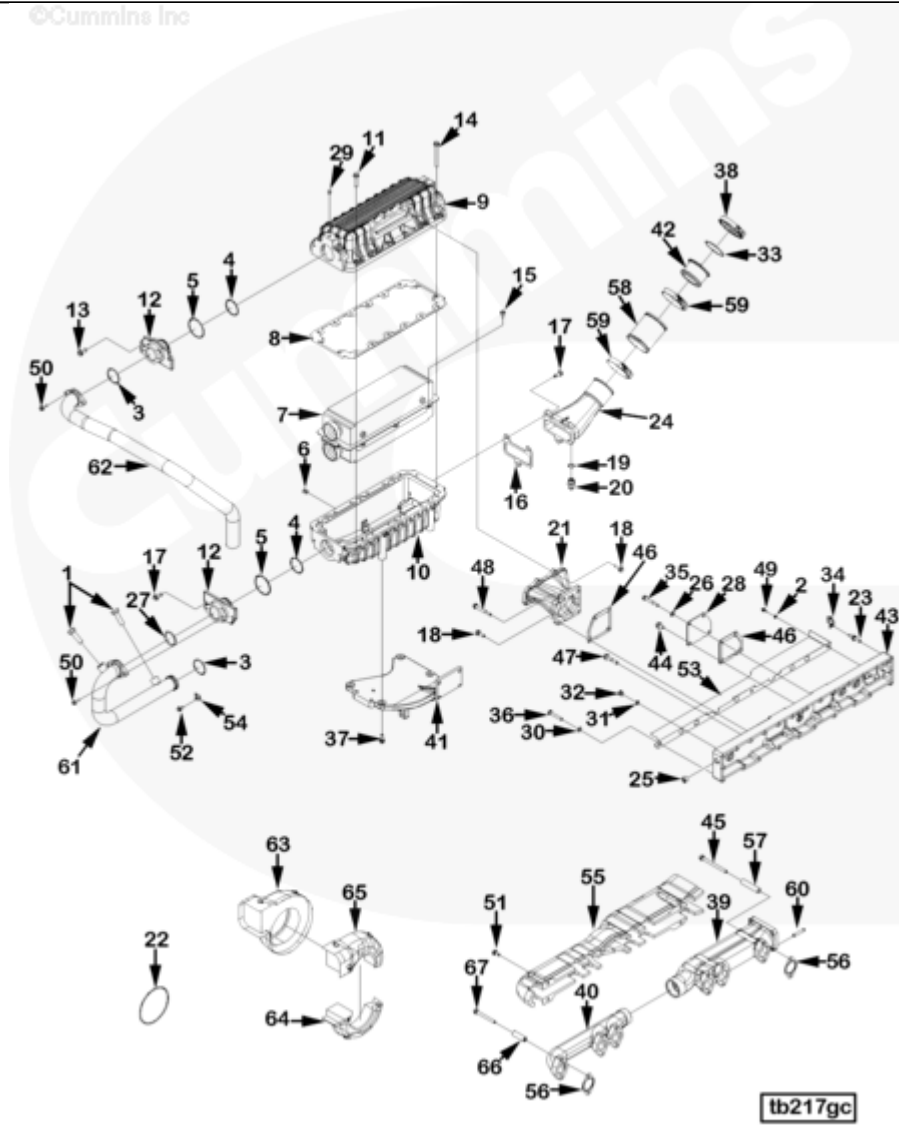

Parts Catalog - Option Detail

Electronic Parts Catalog - Option Detail				
Option	Group	Graphic	Film Card	Date
TB2335	10.06.1	tb217gc	II	12-MAY-12
Engines	ISM CM570, ISM CM570/870, ISM CM875, ISM CM876, ISM CM876 E, ISM11 CM876 M103, ISM11 CM876 SN, M11 CELECT, M11 CELECT PLUS, M11 MECHANICAL, QSM11 CM570, QSM11 CM876			

©Cummins Inc



[SMALL](#) | [MEDIUM](#) | [LARGE](#)

Cart	Ref No	Part Number	Part Description	Required	Remarks
View My Cart					
		TB2335	Turbocharger Arrangement		

					Turbocharger Arrangement
					Turbocharger Location: Rear
					Mount
					Exhaust Outlet Location:
					Side Out
					Exhaust Outlet Size: 88.9mm
					(3.50 in.)
					Turbocharger Centerline
					Vertically from Crank
					Centerline: 510.14mm
					(20.08 in.)
					Turbocharger Horizontal
					Centerline (Ref Rear Face of
					Block): 141.00mm (5.55 in.)
					Engine Aspiration: Sea Water
					Aftercooled
					Front Lifting Bracket
					Location: Front of Air
					Intake Manifold
					Air Ceaner Mounting
					Provision: Yes
					Int. Man. Temp Sensor
					Mounting Loc: Center
					Turbocharger Oil Supply Line
					Type: O Ring Face Seal
					Turbocharger Mounting Flange
					Bolt Circle Diameter:
					132.75mm (5.23 in.)
					Heat Shield Included: Yes
					Insulated Turbine Housing

					Exhaust Outlet Flange Type:
					Half-Marmon
					Exhaust Out Connection
					Mounting Flange Bolt Circle:
					120.7 Insulated Dry Exhaust
					Manifold
<input type="checkbox"/>	1	68241	Zinc Electrode Plug	2	1/2 NPTF x 2 in.
<input type="checkbox"/>	2	112408	Plain Washer	1	1/4 in.
<input type="checkbox"/>	3	145582	O-Ring Seal	2	
		2874979	Aftercooler	1	
<input type="checkbox"/>		3349397	Aftercooler	1	
<input type="checkbox"/>	4	145583	O-Ring Seal	2	
<input type="checkbox"/>	5	145586	O-Ring Seal	2	
<input type="checkbox"/>	6	3278093	Pipe Plug	1	1/4 NPT.
<input type="checkbox"/>	7	3349410	Aftercooler Core	1	
<input type="checkbox"/>	8	3349411	Aftercooler Housing Gasket	1	
<input type="checkbox"/>	9	3349415	Aftercooler Housing	1	
<input type="checkbox"/>	10	3349416	Aftercooler Housing	1	
<input type="checkbox"/>	11	3349461	Hexagon Flange Head Cap Screw	12	
<input type="checkbox"/>	12	3349590	Sea Water Connection	2	
<input type="checkbox"/>	13	3393717	Hexagon Flange Head Cap Screw	4	
<input type="checkbox"/>	14	3393897	Hexagon Flange Head Cap Screw	4	
<input type="checkbox"/>	15	3926846	Hexagon Flange Head Cap Screw	6	M8 X 1.25 X 20.
<input type="checkbox"/>	16	3349541	Connection Gasket	1	
<input type="checkbox"/>	17	3393717	Hexagon Flange Head Cap Screw	3	
<input type="checkbox"/>	18	3903112	Hexagon Flange Head Cap Screw	3	M10 X 1.50 X 30.
<input type="checkbox"/>		3970799	Check Valve	1	
<input type="checkbox"/>	19	3975684	O-Ring Seal	1	

	20	4933267	Check Valve	1	
<input type="checkbox"/>	21	4003348	Air Crossover Connection	1	
<input type="checkbox"/>	22	4019274	O-Ring Seal	1	
<input type="checkbox"/>	23	4026812	Studded Flange Cap Screw	1	
<input type="checkbox"/>	24	4941259	Air Crossover Connection	1	
<input type="checkbox"/>	25	3008468	Pipe Plug	1	1/2 NPT.
<input type="checkbox"/>	26	3009330	Plain Washer	2	M10.
<input type="checkbox"/>	27	3028291	O-Ring Seal	1	
<input type="checkbox"/>	28	3028540	Cover Plate	1	
<input type="checkbox"/>	29	3031511	Pipe Plug	1	1/8 NPT.
<input type="checkbox"/>	30	3036460	Spring Washer	4	
<input type="checkbox"/>		3037536	Threaded Plug	6	9/16 - 18 UNF
<input type="checkbox"/>	31	3037537	O-Ring Seal	1	
	32	3040813	Threaded Plug	1	9/16 - 18 UNF
<input type="checkbox"/>		3066211	O-Ring Seal	1	
<input type="checkbox"/>	34	3073750	Clip	1	
<input type="checkbox"/>	35	3081346	Hexagon Head Cap Screw	2	M10 x 1.50 x 70.
<input type="checkbox"/>	36	3088162	Hexagon Head Cap Screw	4	
<input type="checkbox"/>	37	3093932	Hexagon Flange Head Cap Screw	4	M10 X 1.50 X 25.
<input type="checkbox"/>	38	3094043	V Band Clamp	1	
<input type="checkbox"/>	39	3349393	Exhaust Manifold	1	
<input type="checkbox"/>	40	3349395	Exhaust Manifold	1	
<input type="checkbox"/>	41	3349658	Aftercooler Support	1	
<input type="checkbox"/>	42	3349742	Adapter Connection	1	
<input type="checkbox"/>	43	3406757	Air Intake Manifold	1	
<input type="checkbox"/>	44	3818060	Captive Washer Cap Screw	2	M10 X 1.50 X 25.
<input type="checkbox"/>	45	3818122	Hexagon Flange Head Cap Screw	6	M10 X 1.50 X 130.
<input type="checkbox"/>	46	3818846	Connection Gasket	2	
<input type="checkbox"/>	47	3821847	Captive Washer Cap Screw	14	M10 X 1.50 X 60.
<input type="checkbox"/>	48	3896408	Hexagon Flange Head Cap Screw	2	

<input type="checkbox"/>	49	3900627	Hexagon Flange Head Cap Screw	1	M6 X 1.00 X 14.
<input type="checkbox"/>	50	3900631	Hexagon Flange Head Cap Screw	4	M8 X 1.25 X 25.
<input type="checkbox"/>	18	3903112	Hexagon Flange Head Cap Screw	6	M10 X 1.50 X 30.
<input type="checkbox"/>	51	3903990	Hexagon Flange Head Cap Screw	4	M10 X 1.50 X 20.
<input type="checkbox"/>	52	3925883	Hexagon Flange Head Cap Screw	2	M8 X 1.25 X 16
<input type="checkbox"/>	53	3965080	Heat Shield	1	
<input type="checkbox"/>	54	4003347	Tube Clamp	2	
<input type="checkbox"/>	55	4003595	Heat Shield	1	
<input type="checkbox"/>	56	4019593	Exhaust Manifold Gasket	6	
<input type="checkbox"/>	57	4070659	Mounting Spacer	6	
<input type="checkbox"/>	58	4078469	Plain Hose	1	
<input type="checkbox"/>	59	4086588	T-Bolt Clamp	2	
<input type="checkbox"/>	60	4298242	High Temperature Stud	4	
<input type="checkbox"/>	61	4929174	Water Inlet Tube	1	
<input type="checkbox"/>	62	4933956	Sea Water Pump Tube	1	
<input type="checkbox"/>	63	4944132	Heat Shield	1	
<input type="checkbox"/>	64	4944133	Heat Shield	1	
<input type="checkbox"/>	65	4944134	Heat Shield	1	
<input type="checkbox"/>	66	4965512	Mounting Spacer	6	
<input type="checkbox"/>	67	4965698	Hexagon Flange Head Cap Screw	6	